



# Climbing Wall- Paper Birds (age 3-6 years)

Ref. KP1040 - KP1041

Last check dec./ 2018

Pag. 1/3

EN-1176-1: 1/7



SERIE  
**ANiMALS**  
SERIES



KP1040

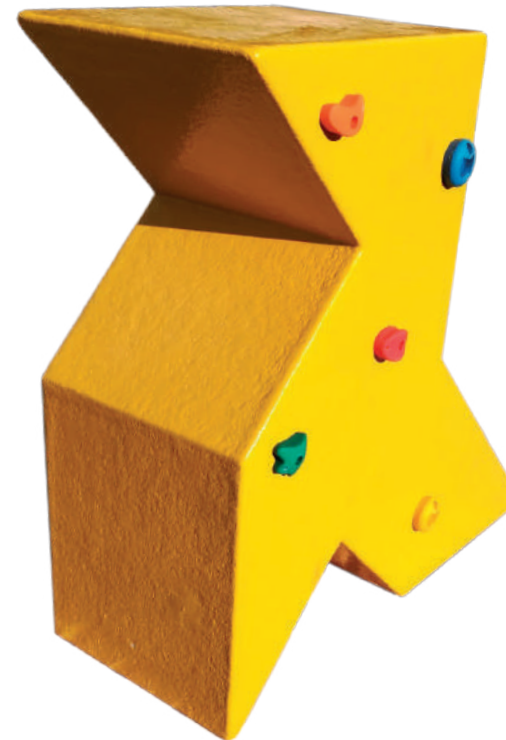

KP1041

## Technical information.

**Structure:** Made of water repellent wood board.

**Finish:** exterior lined in fiberglass sheets with polyphonic coating and mass painted with color to choose.

**Climbing holds:** Made in latest generation polyurethane with rugged finish.

**Screws:** of zinc plates steel.

**Bindings:** High resistance angle brackets made in zinc plates steel.

## Technical data.

**Assembly:** 2 pers. 2 hours.

## Two sizes:

**KP1040-Paper Bird 2,10 m.**

**Total high:** 2,10 m.

**Maximum height fall:** 2,10 m.

**Safety area:** 26,8 m<sup>2</sup>

**Biggest piece dimension:** 2,10 m.

**Spare pieces availability:** 3 years.

**KP1041-Paper Bird 1,20 m.**

**Total high:** 1,20 m.

**Maximum height fall:** 1,20 m.

**Safety area:** 21 m<sup>2</sup>

**Biggest piece dimension:** 1,20 m.

**Spare pieces availability:** 3 years.



C/ Foia, 13  
P.I. Alquería  
de Moret  
46210 Picanya  
(Valencia)



+34 963 313 677



kiwi@kiwipw.com



www.kiwipw.com

The company reserves  
the right to perform  
any modification or  
change in their products.

CLIMBINBG WALLS



# Climbing Wall- Paper Birds (age 3-6 years)

Ref. KP1040 - KP1041

Last check dec./ 2018

Pag. 2/3

EN-1176-1: 1/7



**SERIE**  
**ANIMALS**  
**SERIES**

Safety area KP1041: 21 m<sup>2</sup>

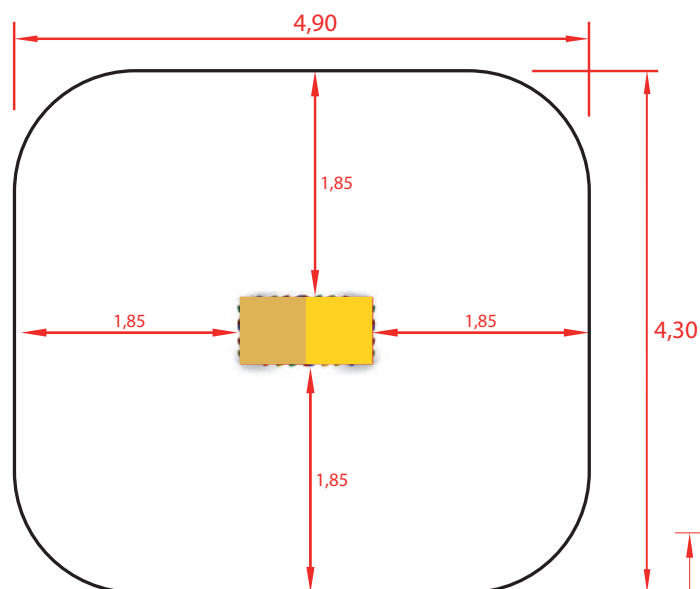

Safety area KP1040: 26,8 m<sup>2</sup>

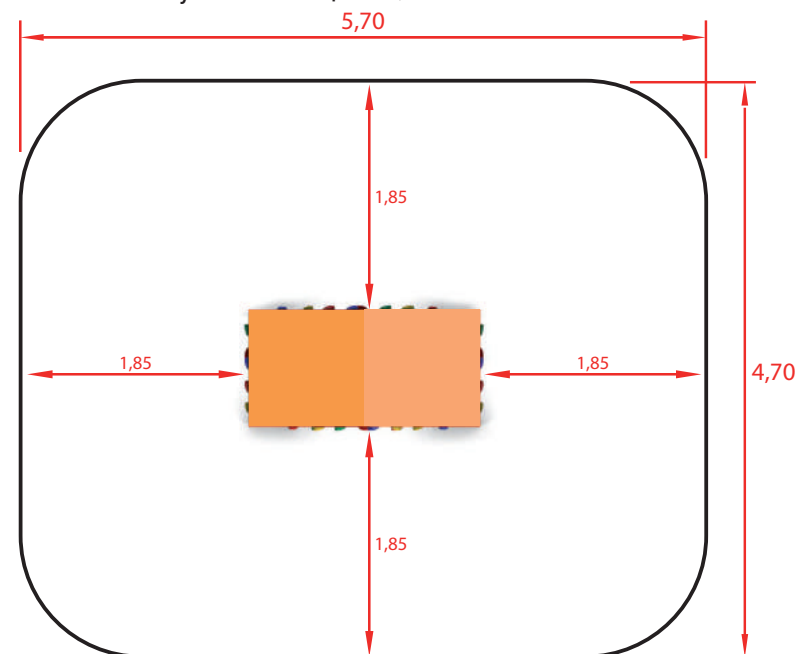

General dimensions  
KP1041 (in meters)

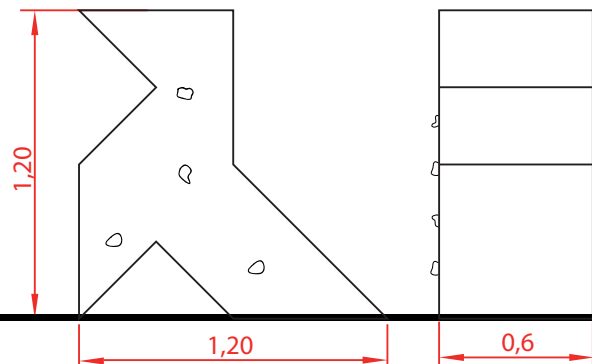

General dimensions  
KP1040 (in meters)

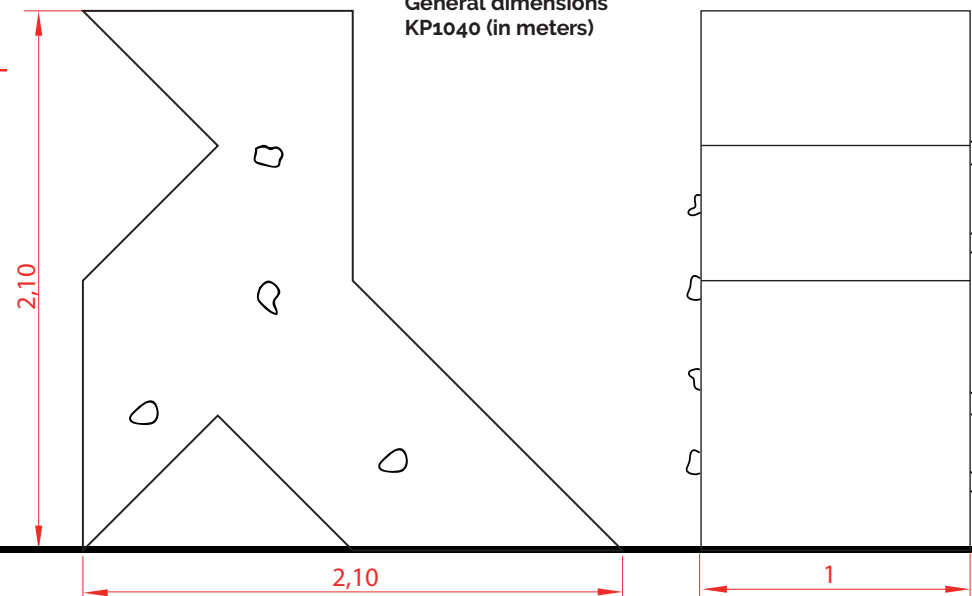

**CLIMBING WALLS**



C/ Foia, 13  
P.I. Alquería  
de Moret  
46210 Picanya  
(Valencia)



+34 963 313 677



kiwi@kiwipw.com



www.kiwipw.com

The company reserves  
the right to perform  
any modification or  
change in their products.



# Climbing Wall- Paper Birds (age 3-6 years)

Ref. KP1040 - KP1041

Last check dec./ 2018

Pag. 3/3

EN-1176-1: 1/7



SERIE  
**ANIMALS**  
SERIES

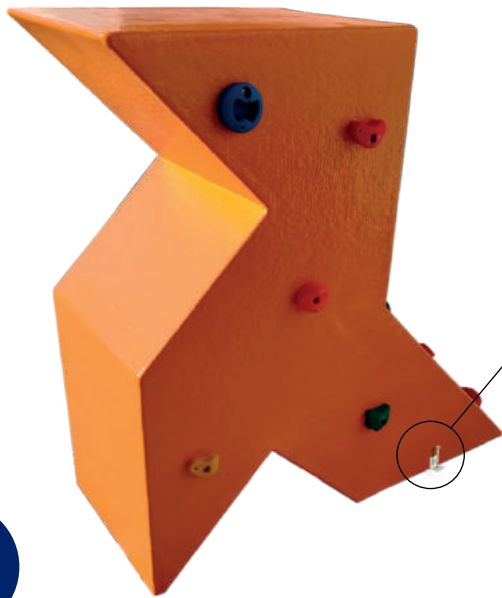

Anchoring detail.

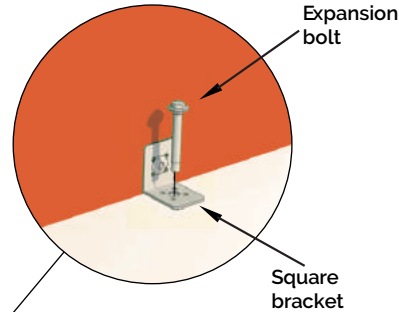

Expansion bolt

Square bracket

## Installation.

Anchored to the floor with expansion bolts. Finished with compacted material coating either continuous wet-pour rubber surfacing or rubber tiles.

## Maintenance.

-Check: All fixing points. Screws and bolts must be periodically checked, then tightened and adjusted if necessary. The checking date must be annotated in order to establish a control.

## Inspections.

-Routine Inspection: A visual and functional inspection must be carried out every 3 months in order to check that the module has suffered no harm due to vandalism or mishandling.

-Yearly Inspection: A full inspection of the entire installation must be done to check that it keeps all norm standards and has suffered no alterations.



C/ Foia, 13  
P.I. Alquería  
de Moret  
46210 Picanya  
(Valencia)



+34 963 313 677



kiwi@kiwipw.com



www.kiwipw.com

The company reserves  
the right to perform  
any modification or  
change in their products.

Dimensions for the concrete slab. KP1040 (in m.)

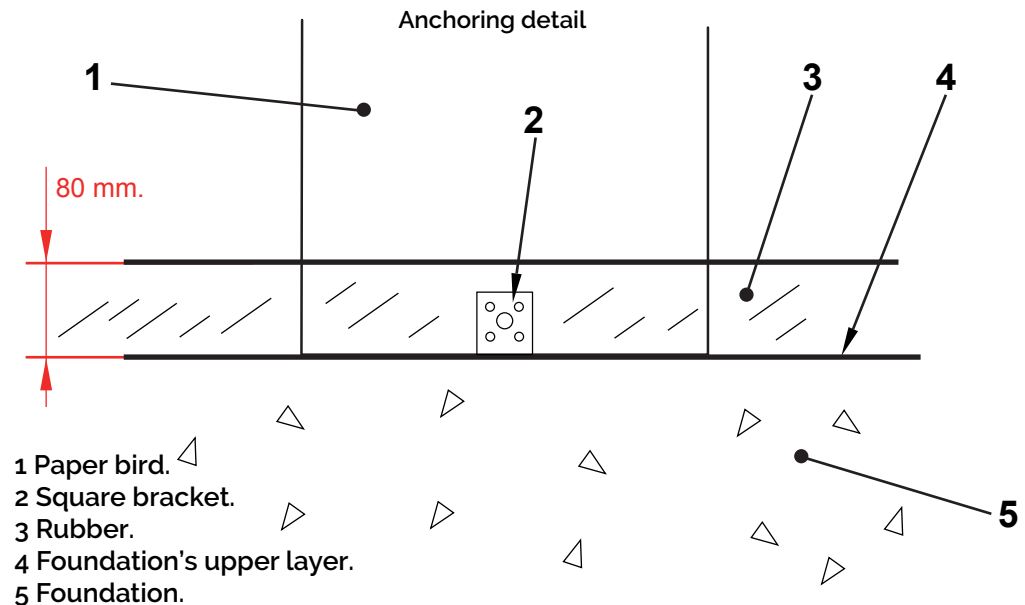
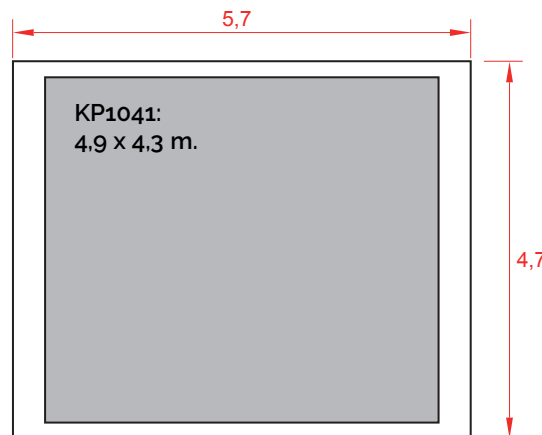

CLIMBING WALLS